

PIASTRE MOTORE - ENGINE MOUNT

GR.M.03/006

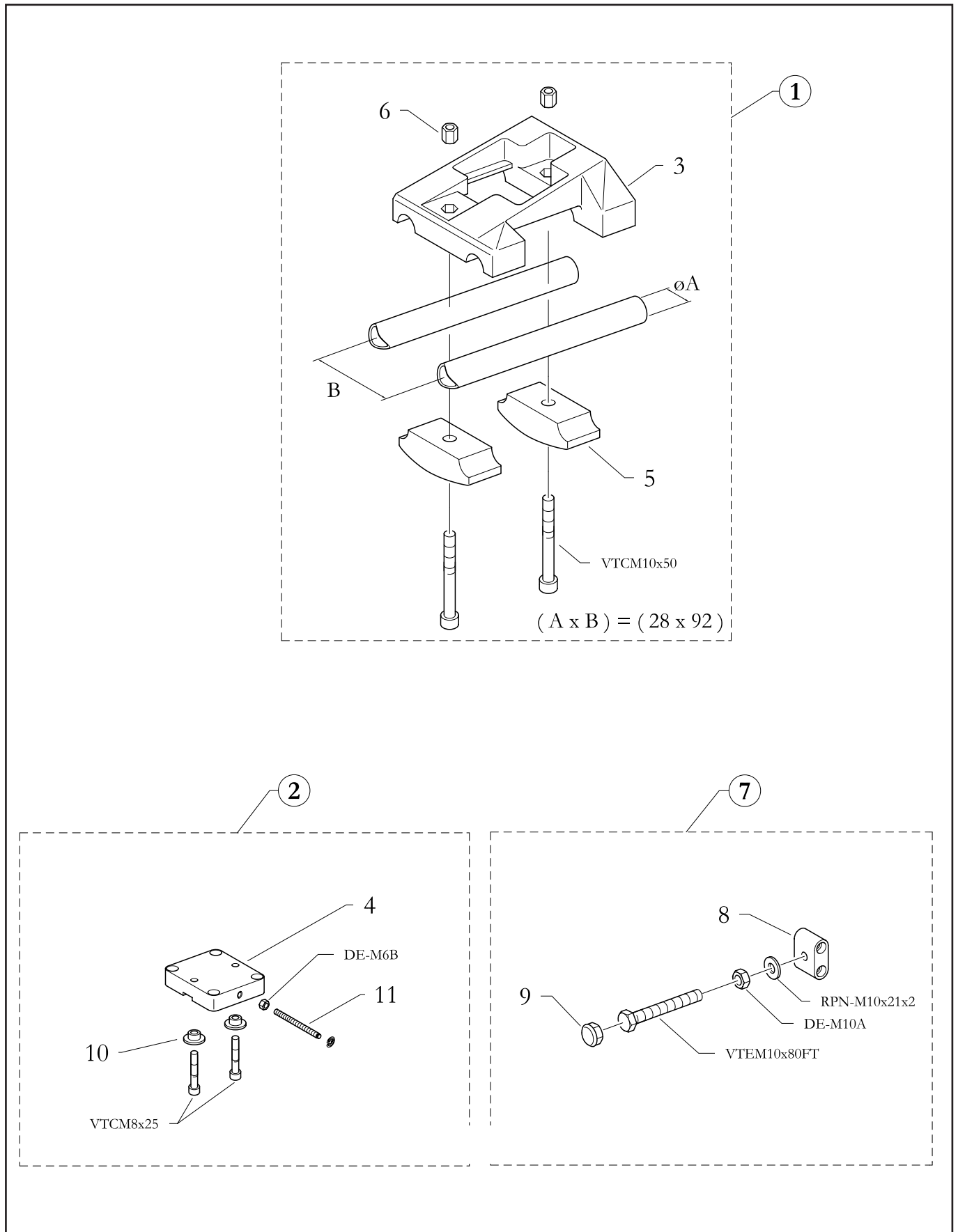

PIASTRE MOTORE - ENGINE MOUNT

GR.M.03/006

Pos.	Cod. Articolo	Descrizione	Description
1	5600.00.78	ASS. PIASTRA MOTORE 28x92 A	ENGINE MOUNT 28x92 A, ASS.
1	5600.00.05	ASS. PIASTRA MOTORE 30x92 A	ENGINE MOUNT 30x92 A, ASS.
1	5600.00.97	ASS. PIASTRA MOTORE 32x92 A	ENGINE MOUNT 32x92 A, ASS.
2	5600.00.60	ASS. PIASTRA MOTORE B25	ENGINE MOUNT B25, ASS.
3	5650.00.15	PIASTRA MOTORE 28x92 A	ENGINE MOUNT 28x92 A
3	5650.00.30	PIASTRA MOTORE 30x92 A	ENGINE MOUNT 30x92 A
3	5650.00.98	PIASTRA MOTORE 32x92 A	ENGINE MOUNT 32x92 A
4	5650.00.60	PIASTRA MOTORE B25	ENGINE MOUNT B25
5	3896.10.01	CAVALLOTTO	MOUNT CLAMP
6	20.1488.06	DADO PIASTRA MOTORE	ENGINE MOUNT NUT
7	10.6448.00-BL	ASSIEME FERMO MOTORE HQ MTS	ENGINE LOCK ASSEMBLY HQ MTS
8	20.4886.10-BL	FERMO MOTORE HQ MTS	ENGINE LOCK HQ MTS
9	20.3201.18	POMOLO FERMO PIASTRA MOTORE	KNOB LOCK ENGINE MOUNT
10	20.0064.06	BOCCOLA GUIDA FUSELLO	SPINDLE AXLE BUSHING
11	20.4957.06	PERNO FISS. CARTER FRIZIONE COMER 50	FIXING PIN CARTER CLUTCH COMER 50

Note: Nella descrizione dell'articolo, la lettera finale identifica il materiale. Legenda materiali: A = Alluminio, F = Ferro, G = Ghisa, M = Magnesio.

Note: In the article description, the final letter identifies the material. Material index: A = Aluminium, F = Iron, G = Cast Iron, M = Magnesium.