

PORTADISCO - DISK CARRIER

GR.M.03/021

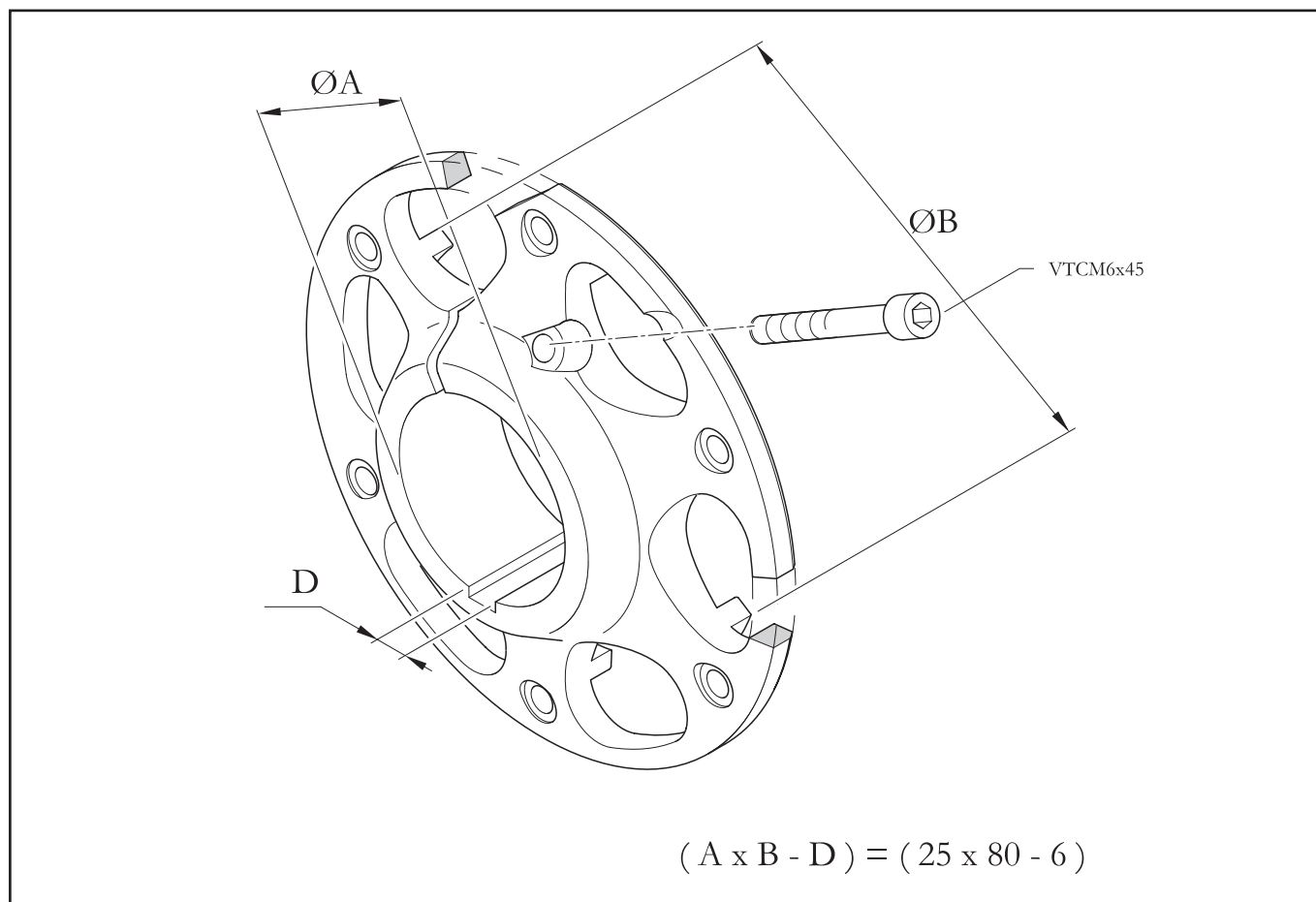

Pos.	Cod. Articolo	Descrizione	Description
1	6016.00.01	PORTADISCO FISSO 25x80-6 A	DISK CARRIER 25x80-6 A, FIX
1	2988.00.01	PORTADISCO FISSO 25x80-6 A HQ	DISK CARRIER 25x80-6 A FIX, HQ
1	2988.00.10	PORTADISCO FISSO C-25x80-6 A HQ	DISK CARRIER C-25x80-6 A FIX, HQ
1	6016.00.02	PORTADISCO FISSO 30x80-6 A	DISK CARRIER 30x80-6 A FIX
1	2988.00.02	PORTADISCO FISSO 30x80-6 A HQ	DISK CARRIER 30x80-6 A FIX, HQ
1	2988.00.11	PORTADISCO FISSO C-30x80-6 A HQ	DISK CARRIER C-30x80-6 A FIX, HQ
1	6016.00.03	PORTADISCO FISSO 40x80-8 A	DISK CARRIER 40x80-8 A FIX
1	2988.00.03	PORTADISCO FISSO 40x80-8 A HQ	DISK CARRIER 40x80-8 A FIX HQ
1	2988.00.07	PORTADISCO FISSO 40x110-8 A HQ	DISK CARRIER 40x110-8 A FIX, HQ
1	2988.00.06	PORTADISCO FISSO 50x110-8 A HQ	DISK CARRIER 50x110-8 A FIX, HQ
1	2988.00.12	PORTADISCO FISSO C-40x80-8 A HQ	DISK CARRIER C-40x80-8 A FIX, HQ

Note: Nella descrizione dell'articolo, la lettera finale identifica il materiale. Legenda materiali: A = Alluminio, F = Ferro, G = Ghisa, M = Magnesio.

Note: In the article description, the final letter identifies the material. Material index: A = Aluminium, F = Iron, G = Cast Iron, M = Magnesium.