

RUOTE "R" - WHEELS "R"

GR.M.03/091

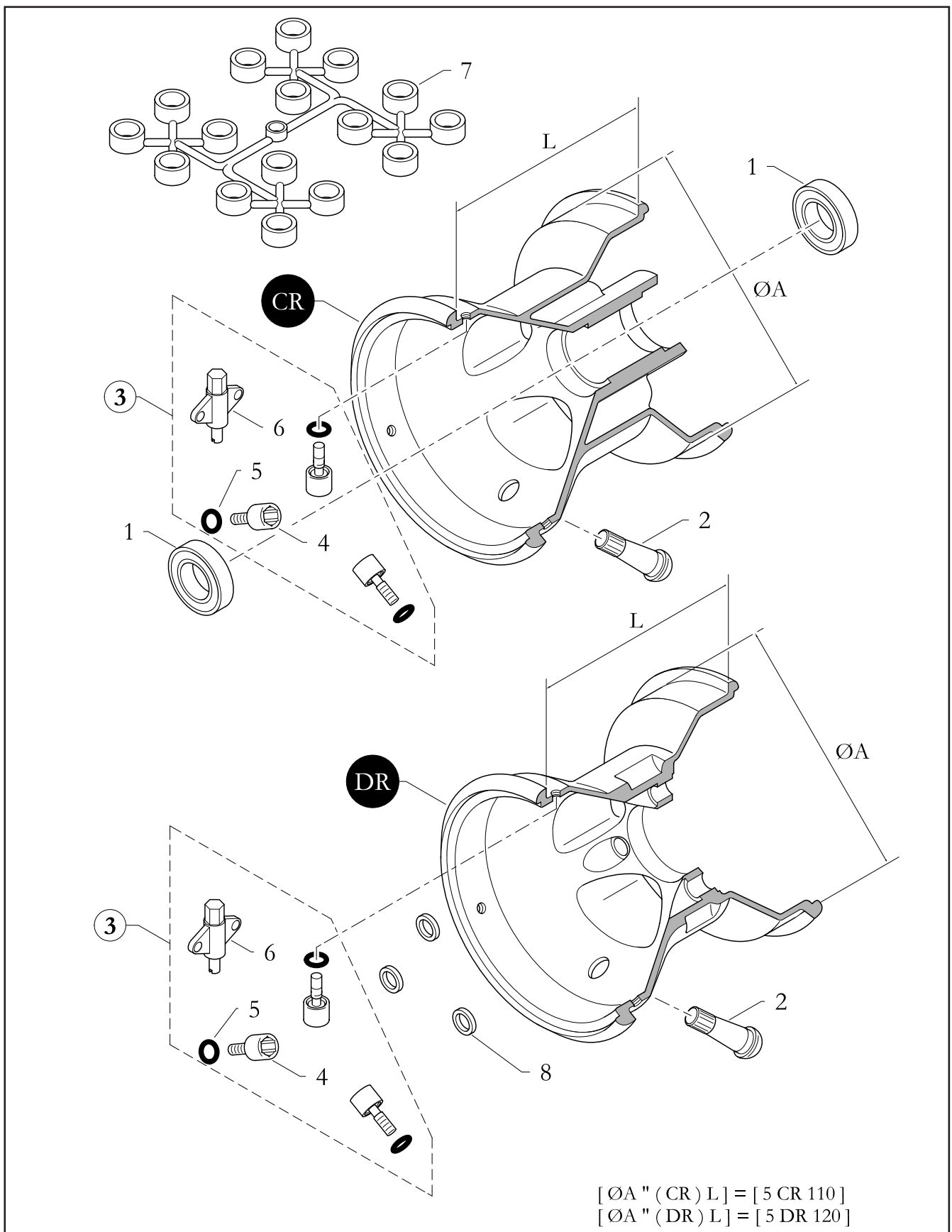

RUOTE "R" - WHEELS "R"

GR.M.03/091

Pos.	Cod. Articolo	Descrizione	Description
CR	5500.10.01-OR	RUOTA 5" CR 115A	WHEEL 5" CR 115A
CR	5400.12.57-OR	RUOTA 5" CR 120M HQ	WHEEL 5" CR 120M HQ
CR	5400.12.58-OR	RUOTA 5" CR 130M HQ	WHEEL 5" CR 130M HQ
DR	5400.12.59-OR	RUOTA 5" DR 120M HQ	WHEEL 5" DR 120M HQ
DR	5400.12.60-OR	RUOTA 5" DR 130M HQ	WHEEL 5" DR 130M HQ
DR	5500.10.02-OR	RUOTA 5" DR 150A	WHEEL 5" DR 150A
DR	5400.12.63-OR	RUOTA 5" DR 180M HQ	WHEEL 5" DR 180M HQ
DR	5400.12.64-OR	RUOTA 5" DR 210M HQ	WHEEL 5" DR 210M HQ
CR	6700.00.02-OR	SET RUOTE 5"CR115/17+17-DR150A	WHEEL SET 5"CR115/17+17-DR150A
CR	5450.00.82-OR	SET RUOTE 5"CR120/17+17-DR180M	WHEEL SET 5"CR120/17+17-DR180M
CR	5450.00.06-OR	SET RUOTE 5"CR130/17+17-DR180M	WHEEL SET 5"CR130/17+17-DR180M
CR	5450.00.86-OR	SET RUOTE 5"CR130/17+17-DR210M	WHEEL SET 5"CR130/17+17-DR210M
DR	5450.00.83-OR	SET RUOTE 5"DR120-DR180M HQ	WHEEL SET 5"DR120-DR180M HQ
DR	5450.00.07-OR	SET RUOTE 5"DR130-DR180M HQ	WHEEL SET 5"DR130-DR180M HQ
DR	5450.00.87-OR	SET RUOTE 5"DR130-DR210M HQ	WHEEL SET 5"DR130-DR210M HQ
1	6003-ZZ	CUSCINETTO	BEARING
2	40.2166.00	VALVOLA TUBELESS CORTA	TUBELESS VALVE, SHORT
3	10.5805.00	KIT ANTISTALLONAMENTO M HQ	BEAD LOCK KIT M HQ
4	20.3534.06	VITE ANTISTALLONAMENTO	BEAD LOCK SCREW
5	40.3594.00	OR VITE ANTISTALLONAMENTO	OR BEAD RETAINER
6	20.3924.18	CHIAVE SMONTAVALVOLE	VALVE REMOVE KEY
7	10.2000.00	GRUPPO DISTANZIALI RUOTE	WHEEL SPACER GROUP
8	20.3729.06	ROSETTA 8x15x3	WASHER 8x15x3

Note: Nella descrizione dell'articolo, la lettera finale identifica il materiale.

Legenda materiali: A = Alluminio, F = Ferro, G = Ghisa, M = Magnesio.

Nel colore, le lettere finali identificano il colore.

Legenda colori: BA = Bianco, BL = Blu, GL = Giallo, LU = Lucido, NE = Nero, OR = Oro, RO = Rosso, VE = Verde, MC = Multicolor.

I sets di ruote, nelle varie combinazioni, si intendono completi di: cuscinetti o anelli di fissaggio, valvole, tubeless ed viti antistallanamento.

Note: In the article description, the final letter identifies the material.

Material index: A = Aluminium, F = Iron, G = Cast iron, M = Magnesium.

The final letters in the code identify the colour.

Colour index: BA = White, BL = Blue, GL = Yellow, LU = Bright, NE = Black, OR = Gold, RO = Red, VE = Green, MC = Multicolor.

The wheel sets, in the different version, are completed with bearings or stop ring, tubeless valves and bead locks.